

- 1
- 2
- 3
- 4
- 5
- 6
- 7
- 8
- 9
- 10
- 11
- 12
- 13
- 14
- 15
- 16
- 17
- 18

MATERIAL

AISI 304 stainless steel, matte finish.

FEATURES AND APPLICATIONS

GN 2376 plates are a useful accessory for GN 7237 jointed hinges (see page ...)

They remove the need for threads, bolts, nuts, and washers during installation, allowing pre-installation work to be eliminated that would otherwise be necessary for positioning during tightening or loosening. They can be fixed externally via pass-through holes in the housing wall or alternatively via welding inside the structure.

This provides effective protection against vandalism, keeping the outside of the application free from non-aesthetic elements such as screws, nuts, etc. and also improving its cleanability.

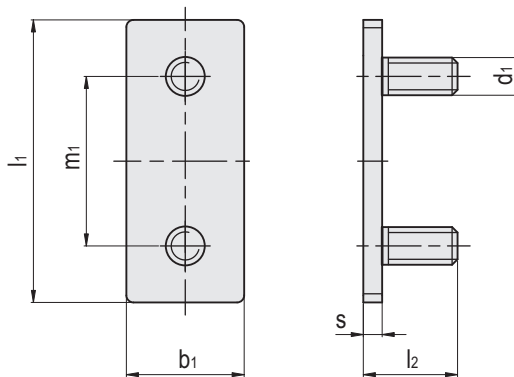
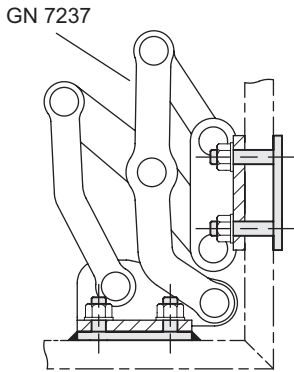
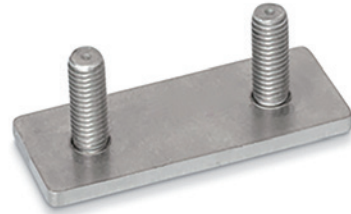

Conversion Table	
1 mm = 0,039 inch	
l1	
mm	inch
40	1.57
50	1.97
60	2.36

Code	Description	l1	l2	d1	b1	m1	s	⚖️
GN.39051	GN 2376-NI-40-15-MT	40	15	M5	15	25	3	17
GN.39056	GN 2376-NI-40-25-MT	40	25	M5	15	25	3	19
GN.39061	GN 2376-NI-50-20-MT	50	20	M6	20	30	3	30
GN.39066	GN 2376-NI-50-30-MT	50	30	M6	20	30	3	33
GN.39071	GN 2376-NI-60-20-MT	60	20	M8	25	36	4	46
GN.39076	GN 2376-NI-60-30-MT	60	30	M8	25	36	4	52